

Hipharma AL/ST/STZ/UPVC Movable Wall

Self-supporting wall provided in modular units consisting of external skins in powder coated aluminium (AL), powder coated steel (ST), galvanized steel (STZ) or UPVC.

Aluminium thickness: 1mm

Powder coated and galvanized steel thickness: 0,8mm

Steel coated with UPVC: total thickness 0,8mm

Standard panel dimension is 1200x3000mm (WxH) (approx: 4'x10')

Standard panel thickness is 45mm (1 3/4").

Additional wall heights can be achieved by using a stacking technique.

Panel to panel connections are maintained with precision by alu profiles that create uniform seams.

Movable wall includes:

- skin layers in powder coated aluminium (AL), powder coated steel (ST), galvanized steel (STZ) or UPVC.
- insulation material
- welded rectangular aluminum framework
- H Aluminium profile between wall sections (4mm seal gap precision)
- 15mm (5/8"), 70mm (2 3/4") or 120mm (4 3/4") aluminum floor trail for panel support
- Food grade silicone sealant to caulk panel seams

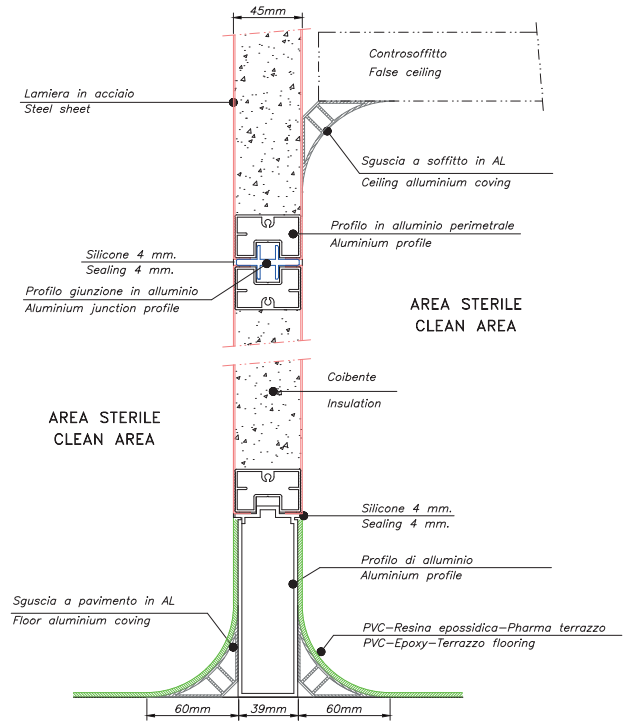

MOVABLE WALL CODE	WALL THICKNESS	POWDER COATED ALUMINIUM	POWDER COATED STEEL	GALVANIZED STEEL (*)	UPVC	ANTI-BACTERICAL UPVC	INSULATION MATERIALS AND THEIR TECHNICAL FEATURES			
							POLYSTYRENE (HDP)	POLYURETHANE (PUR or PIR)	HONEYCOMB (HC)	ROCKWOOL (RW)
							Density: 35Kg./m ³	Density: 35Kg./m ³	Density: 40Kg./m ³	Density: 130Kg./m ³
										Vertical oriented fibers
W45-AL-HDP-AL 11069/05/9990	45mm	●								
W45-ST-HDP-ST 11069/05/9990			●							
W45-ST.AG-HDP-ST.AG 11069/05/9990							●			
W45-STZ-HDP-STZ 11069/05/9990					●					
W45-ST/UPVC-HDP-AL 22317/05/22495						●				
W45-AL-HDPU-AL 11069/05/9990	45mm	●								
W45-ST-HDPU-ST 11069/05/9990			●							
W45-ST.AG-HDPU-ST.AG 11069/05/9990							●			
W45-STZ-HDPU-STZ 11069/05/9990					●					
W45-ST/UPVC-HDPU-AL 22317/05/22495						●				
W45-AL-HC-AL 11069/05/9990	45mm	●								
W45-ST-HC-ST 11069/05/9990			●							
W45-ST.AG-HC-ST.AG 11069/05/9990							●		●	
W45-STZ-HC-STZ 11069/05/9990					●					
W45-ST/UPVC-HC-AL 22317/05/22495						●				
W45-AL-RW-AL 11069/05/9990	45mm	●								
W45-ST-RW-ST 11069/05/9990			●							
W45-ST.AG-RW-ST.AG 11069/05/9990							●			●
W45-STZ-RW-STZ 11069/05/9990					●					
W45-ST/UPVC-RW-AL 22317/05/22495						●				

(*) to be coated separately

Hipharma AL/ST/STZ/UPVC Movable Wall

POWDER COATED ALUMINIUM		STANDARDS
Alloy	EN-AW 5005	UNI EN 573/3
Physical state	H42	EN 515
Paint type	PE powder, without TGIC	EN 1396
Rm	Mpa 125 ÷ 165	EN 1396
Rp0,2	Mpa 80 min	EN 1396
A50mm	% 5 min	EN 1396
Paint thickness	55 µm (45 min.)	EN 13523-1
Pencil hardness	H KOH-I-NOR	EN 13523-4
Gloss @60°	80 units min.	EN 13523-2
Adhesion 90°/180°	100%	
Resistance to bending	0,5 T	EN 13523-7
Resistance to Hydrogen Peroxide	the paint doesn't change colour or gloss after immersion for 96 hours in a H2O2 solution at 60°C. The test procedure should simulate the sterilization process through O2 gas	

MOVABLE WALL CODE	STANDARDS	CLASS
W45-AL-HC-AL 11069/05/9990	UNI EN 13501-1:2009	A2-s1,d0
W45-ST-HC-ST 11069/05/9990		
W45-STZ-HC-STZ 11069/05/9990		
W45-AL-RW-AL 11069/05/9990		
W45-ST-RW-ST 11069/05/9990		
W45-STZ-RW-STZ 11069/05/9990		
W45-ST/UPVC-HC-AL 22317/05/22495	UNI EN 13501-1:2009	A2-s2,d0
W45-ST/UPVC-RW-AL 22317/05/22495		
W45-ST.AG-HC-ST.AG 11069/05/9990	UNI EN 13501-1:2009	B-s1,d0
W45-ST.AG-RW-ST.AG 11069/05/9990		
W45-AL-HDP-AL 11069/05/9990	UNI EN 13501-1:2009	B-s2,d0
W45-ST-HDP-ST 11069/05/9990		
W45-STZ-HDP-STZ 11069/05/9990		
W45-AL-HDPU-AL 11069/05/9990		
W45-ST-HDPU-ST 11069/05/9990		
W45-STZ-HDPU-STZ 11069/05/9990		
W45-ST/UPVC-HDP-AL 22317/05/22495		
W45-ST/UPVC-HDPU-AL 22317/05/22495		
W45-ST.AG-HDP-ST.AG 11069/05/9990		
W45-ST.AG-HDPU-ST.AG 11069/05/9990		

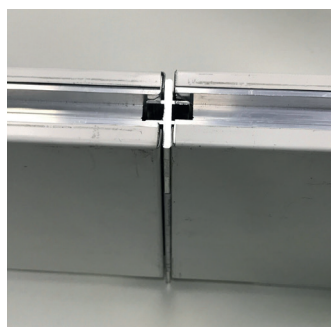

POWDER COATED GALVANIZED STEEL		STANDARDS
Galvanized Coating	150 ± 10 g/m2	
Finishing	Metallic coat MB	
Specular gloss	30 ± 5 gloss	ECCA T2
Pencil hardness	HB-H	ECCA T4
Resistance to salt spray fog	≥ 400 h	ECCA T7
Water immersion resistance	≥ 1000 h	ECCA T9
Resistance to atmospheric agents	8 Cielab	ASTM D 659
Resistance to cracking on bending	after bending at ≥1,5 T and ≥2,5 T the paint does not chip	ECCA T7

UPVC		STANDARDS
Nominal thickness (coating film)	100 µm	
T-bend	1/2 T	EN 13523-7
Salt fog resistance	500 hours	EN 13523-8
		ASTM B117-16
Relative humidity resistance	1000 hours	ASTM D4585-13
Gloss @60°	40 ± 5	EN 13523-2
Resistance to abrasion	13-14 (at 1000runs)	ASTM D4060-95
Resistance to: NaCl - H2SO4 at 2% - NaOH at 5% Denatured ethyl alcohol Merk Buffer pH 10	24 hours	EN 13523-18 D 1308-2

UPVC ANTIBACTERIAL SANISTEEL VERSION WITH SILVER IONES		STANDARDS
Nominal thickness (coating film)	100 µ - 200 µ	
T-bend	1/2 T	ECCA T7
Salt fog resistance	500 hours	ASTM B117-95
		ECCA T8
Relative humidity resistance	1000 hours	ASTM D224794
Pencil hardness	HB	ASTM D3363-92a
		ECCA T4
Gloss @60°	40 ± 5	ASTM D523-89
		ECCA T2
Resistance to abrasion	13-14 (at 1000runs)	ASTM D4060-95
Resistance to NaOH at 5%	16 hours	ASTM D1308-87 ECCA T18
Resistance to bacterial strain: Escherichia coli, Klebsiella pneumoniae, Staphylococcus aureus, Salmonella typhimurium, Listeria monocytogenes, Legionella pneumophilla, Pseudomonas aeruginosa		ISO 22196:2007 ASTM E2180-07 JISZ 2801

