

Hipharma HPL DOUBLE SWING OUT DOORS

Nicomac DOUBLE SWING OUT DOORS are designed to fit flush on both sides of the wall panel system.

They are supplied in several sizes.

All hinge fasteners and latches are recessed in the door frame.

Door panel includes:

- skin layers in high pressure laminate PL
- insulation material
- internal welded rectangular aluminum framework
- external frame manufactured with round anodized or powder coated alu profiles (depending on customer's request) with air tight dual gaskets
- H Aluminum profile between wall sections (0.4mm seal gap precision)
- Food grade silicone sealant to caulk panel seams.

Nicomac DOUBLE SWING OUT DOORS can be integrated inside existing brick walls by means of a special anodized profile.



DOUBLE SWING OUT DOOR CODE	DOOR THICKNESS	INSULATION MATERIALS AND THEIR TECHNICAL FEATURES			
		POLYSTYRENE (HDP)	POLYURETHANE (PUR OR PIR)	HONEYCOMB (HC)	ROCKWOOL (RW)
		Density: 35Kg./m ³	Density: 35Kg./m ³	Density: 40Kg./m ³	Density: 130Kg./m ³ Vertical oriented fibers
DB45-PL-HDP-AL 12/5930	45mm	●			
DB45-PL-HDPU-AL 12/5930	45mm		●		
DB45-PL-PIR-AL 12/5930	45mm		●		
DB45-PL-HC-AL 12/5930	45mm			●	
DB45-PL-RW-AL 12/5930	45mm				●

DOOR CODE	CERTIFICATION AUTHORITY	FIRE CLASS
DB45-PL-RW-AL 12/5930	ASTM E84-12a	A
	UNI EN ISO 11925-2:2005	B-s2, d0
	UNI EN ISO 13501-1:2009	
	UNI EN ISO 13823:2010	
DB45-PL-HDPU-AL 12/5930	ASTM E84-12a	B
DB45-PL-HDP-AL 12/5930		
DB45-PL-PIR-AL 12/5930	ASTM E84-12a	B

THERMAL CONDUCTIVITY	STANDARD	UNIT	VALUE
HPL plastic laminate	DIN 52612	W/m.°K	0,25
Polystyrene (HDP)	EN 12667	W/mK	0,033
Polyurethane (PUR or PIR)	ASTM C 518	Mw/m°K	22,8
Honeycomb (HC)	N.A.		
Rockwool (RW)	EN 12667	W/mK	0,040

DOOR ACCESSORIES
Internal self closing system complete with stop
External self closing system complete with arm and stop
Stainless steel fixed knob
Fixed knob in silver colour
Open close knob in silver colour with key-key
Stainless steel push plate
Aluminium or stainless handle
Anti panic handle (first wing)
Anti panic handle (second wing)
Air tight guillotine (drop seal) to maintain differential air pressure
Aluminium or stainless steel kickplate

DOOR INTERLOCKING SYSTEM
PLC Operated door interlock, MECHANICAL type (it includes light indicators, covers, cables and mechanical lock)
PLC Operated door interlock, SEMAPHORIC type (it includes light indicators, covers and cables)
Magnetic closure (it includes four magnets inside door frame)

Hipharma HPL DOUBLE SWING OUT DOORS

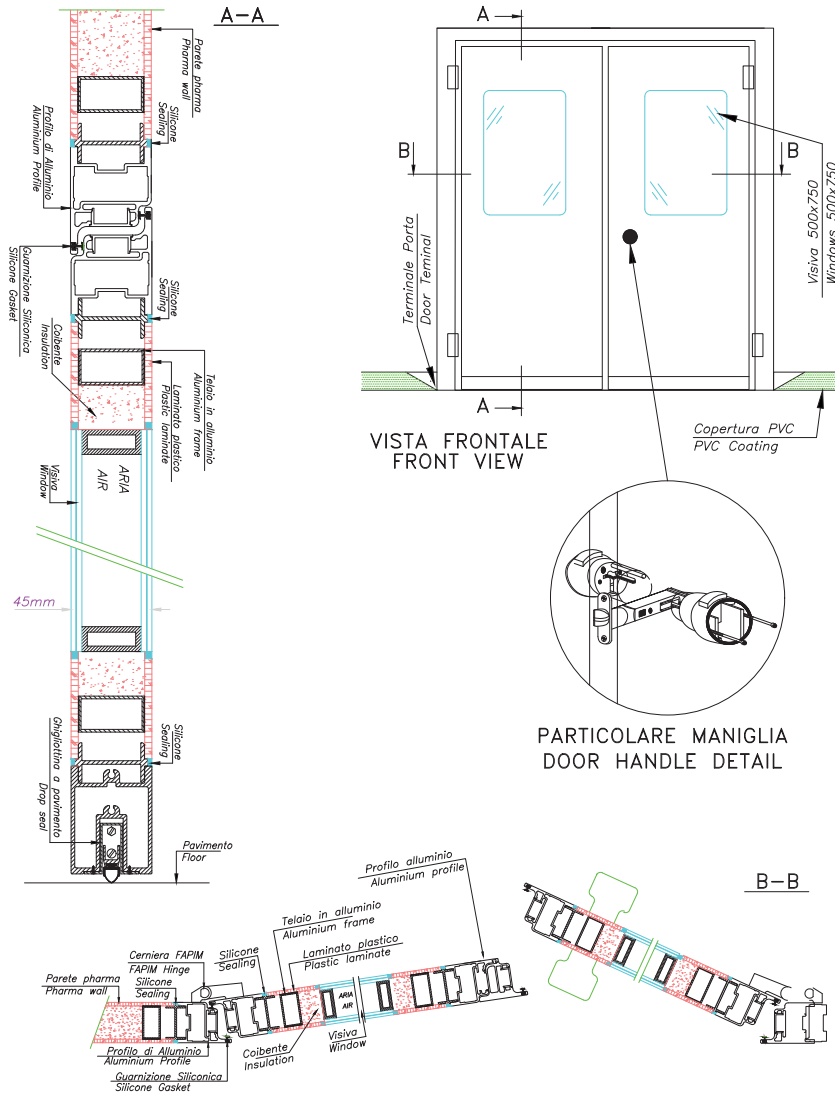

HIGH PLASTIC LAMINATE	TEST METHOD (EN 438:2005)	PROPERTY OR ATTRIBUTE	UNIT	VALUES
Resistance to surface wear	EN 438-2.10	Wear resistance	revs	IP \geq 150 A \geq 350
Stability at elevated temperature	EN 438-2.17	Cumulative dimensional change	% long.	$2 \leq t < 5 \leq 0,40$
			% transv.	$\leq 0,80$
			% long.	$5 \leq t \leq 0,30$
			% transv.	$\leq 0,60$
Resistance to scratching	EN 438-2.25	Force smooth finish	rating	≥ 2
		Force textured finish		≥ 3
Resistance to cigarette burns	EN 438-2.30	Appearance	rating	≥ 3
Resistance to water steam	EN 438-2.14	Gloss finish	rating	≥ 3
		Other finishes		≥ 4
Coefficient of linear thermal expansion	ASTM D 696	-	$^{\circ}\text{C}^{-1}$	L= $1,6 \times 10^{-5}$ ca. T= $3,5 \times 10^{-5}$ ca.
Fire behaviour	EN 13501-1	B-s2, d0		