



HI

**HIPHARMA
MODULAR
CLEANROOM**



Nicomac is leader in the pharmaceutical clean rooms, coating systems and granulators market for pharmaceutical, life science and healthcare industries. Founded in 1977 in Milan, Italy, in so many years of activity it has completed over 1.800 projects in 65 Countries around the world.

Certified quality, materials and an expert and qualified team are at the base of Nicomac's success and customer satisfaction, many of them FDA/EMA approved.



9
Patented systems

15
New devices or
novelties

4.500m²
of production site

65
Countries served

1.800+
successful projects

40+
years of experience

Federal Standard 209E Airborne Particulate Cleanliness Classes

CLASS	NUMBER OF PARTICLES PER CUBIC METER BY MICROMETER SIZE ISO 14644-1						FED STD 209E (0.5 µm)		EMA
	0.1 µm	0.2 µm	0.3 µm	0.5 µm	1 µm	5 µm	English Cu ft	Metric	
ISO 1	10	2	-	-	-	-	-	-	-
ISO 2	100	24	10	4	-	-	-	-	-
ISO 3	1.000	237	102	35	8	-	1	M 1.5	-
ISO 4	10.000	2.370	1.020	352	83	-	10	M 2.5	-
ISO 5	100.000	23.700	10.200	3.520	832	29	100	M 3.5	A / B
ISO 6	1.000.000	237.000	102.000	35.200	8.320	293	1.000	M 4.5	-
ISO 7	-	-	-	352.000	83.200	2.930	10.000	M 5.5	C
ISO 8	-	-	-	3.520.000	832.000	29.300	100.000	M 6.5	D
ISO 9	-	-	-	35.200.000	8.320.000	293.000	-	-	-

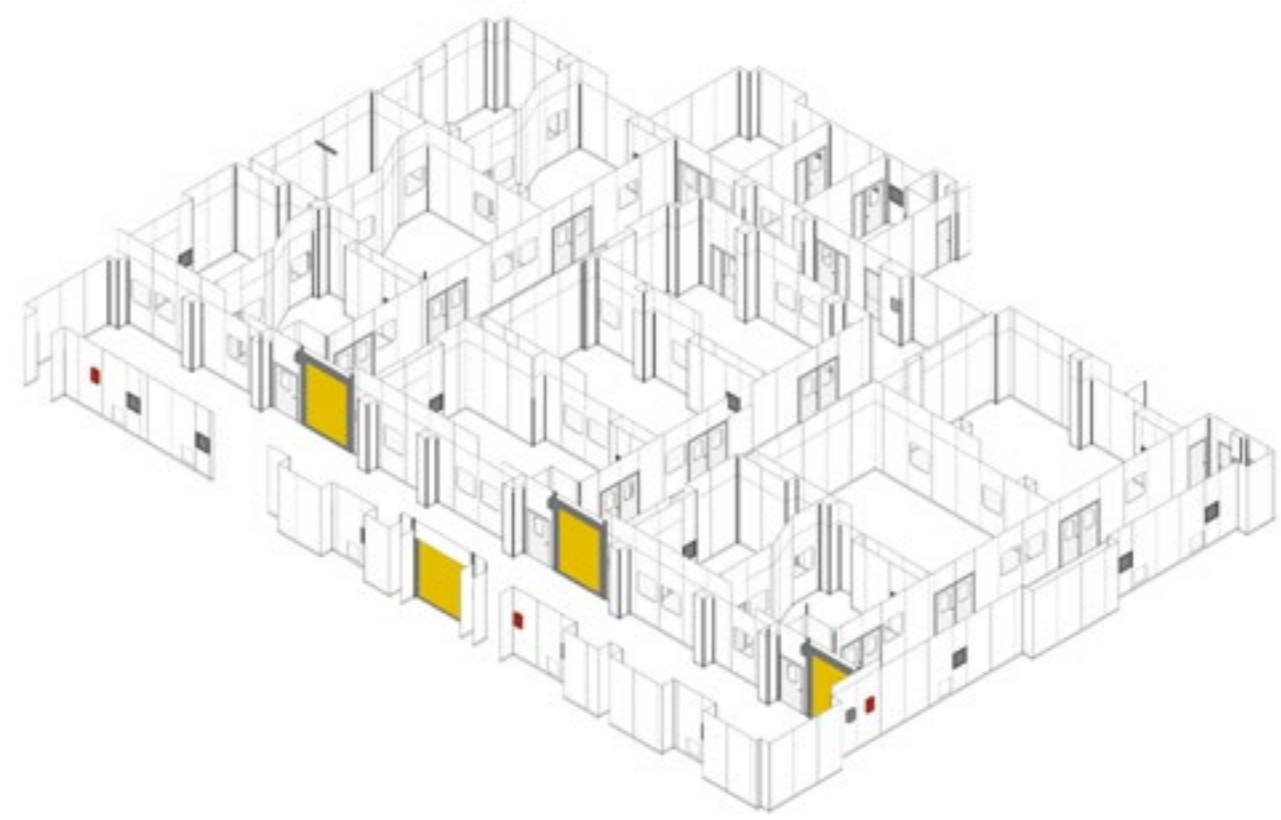

Nicomac: your one-stop supplier for all your cleanroom needs

Building Information Modeling (BIM) is the most advanced process of creating and managing information for built asset and cleanroom in the Architecture, Engineering and Construction industry (AEC). That process allows to plan, verify and prevent any possible interference among all system at site and managing the life cycle assets (Structural, Civil, MEP).

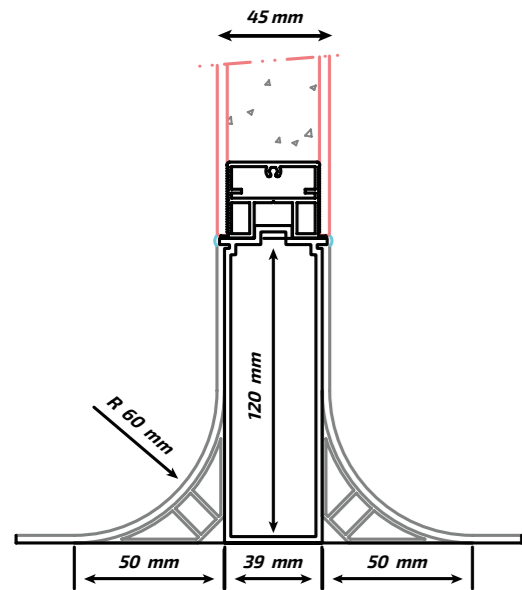

Aluminium coving profiles covered with PVC flooring for a completely smooth surface

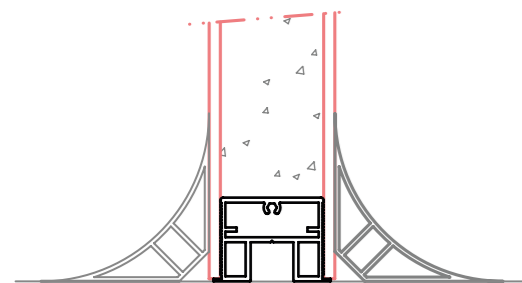

Aluminium coving profiles at sight applied after floor treatment



Floor to wall connections

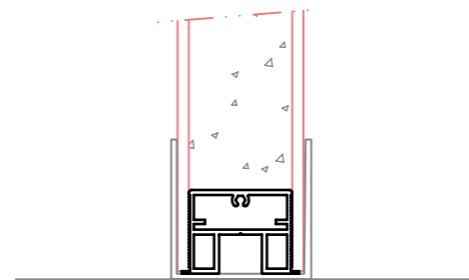

Aluminium kickplate for not classified areas

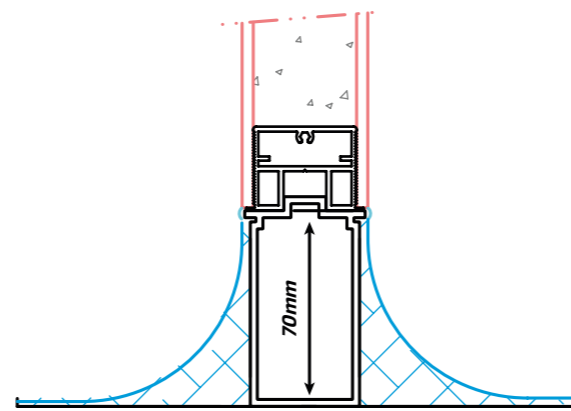

Technical solution for epoxy resin floor smooth surfaces

Wall to wall connections

Round solutions for internal and external vertical corners

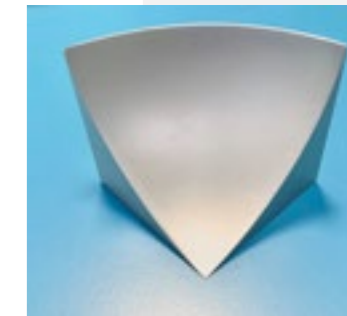
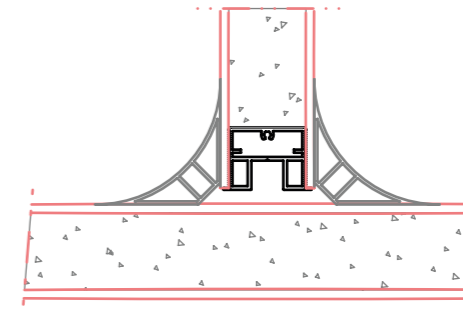
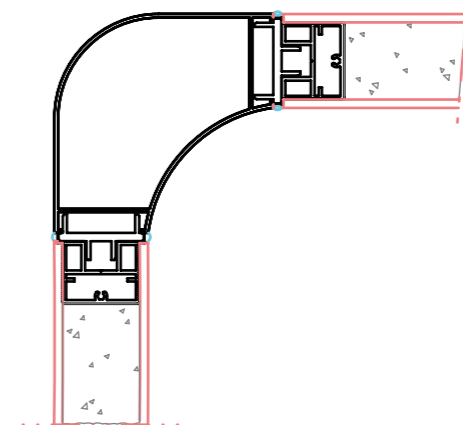
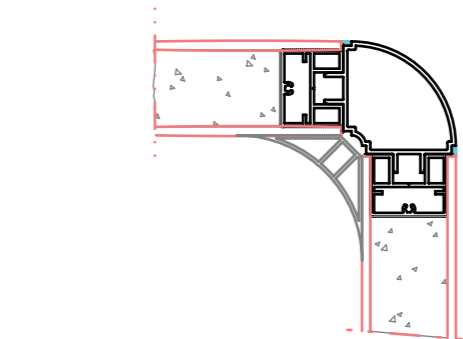

1/8 of sphere



1/4 of sphere

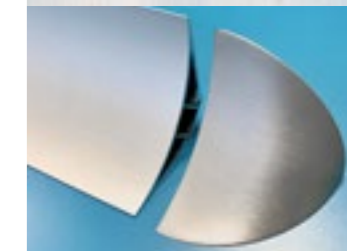

Terminal connection for doors

Wall to ceiling connections

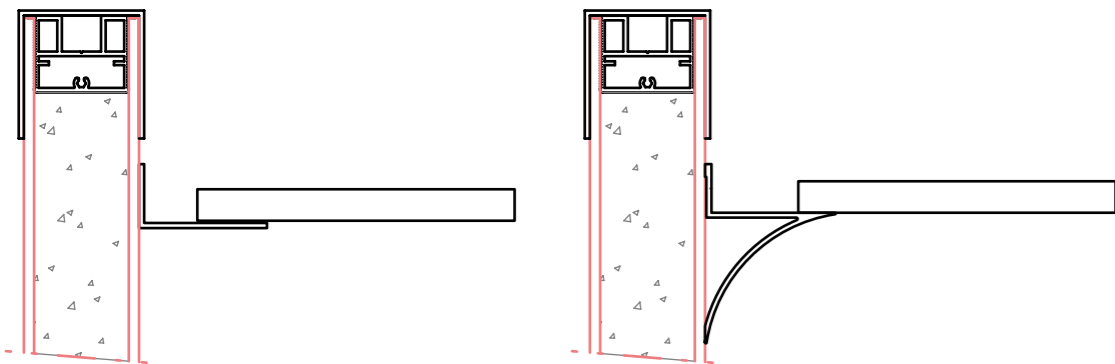

Wall to wall connections

Easy solution for internal and external vertical corners

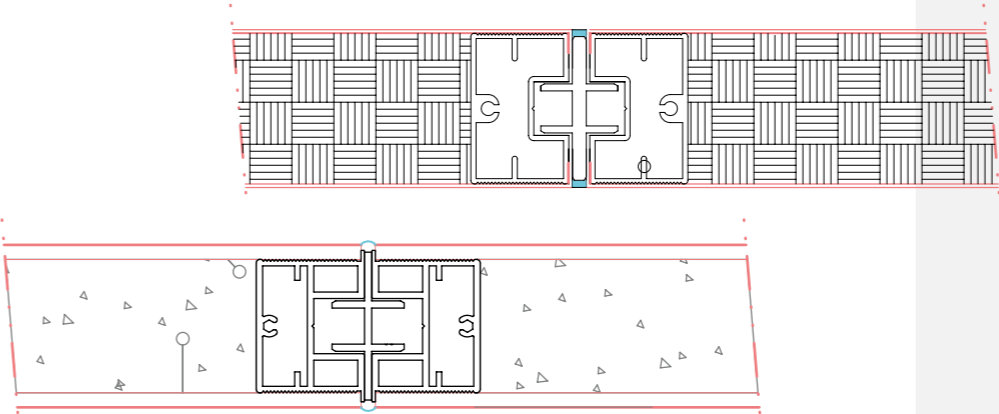
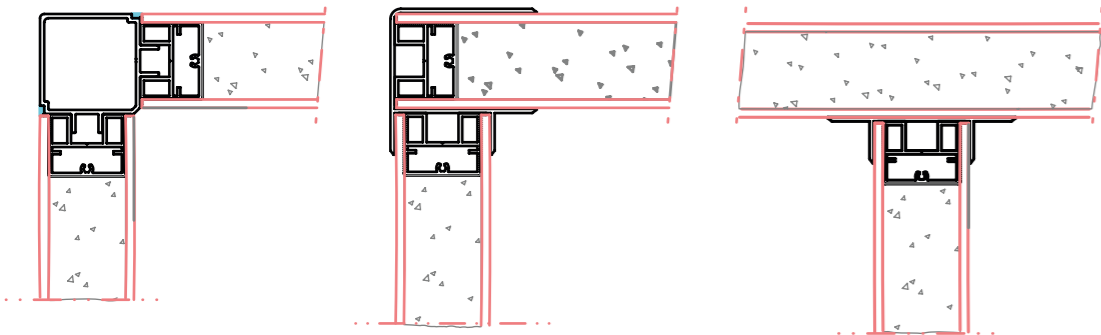

Wall Panels Skin

- HPL** High Pressure Laminate 4 mm. thickness
- GA** Powder-coated galvanized steel
- AL** Aluminium steel sheets
- ST/ST** Stainless steel AISI 304 sheets
- UPVC** uPVC coated galvanized steel

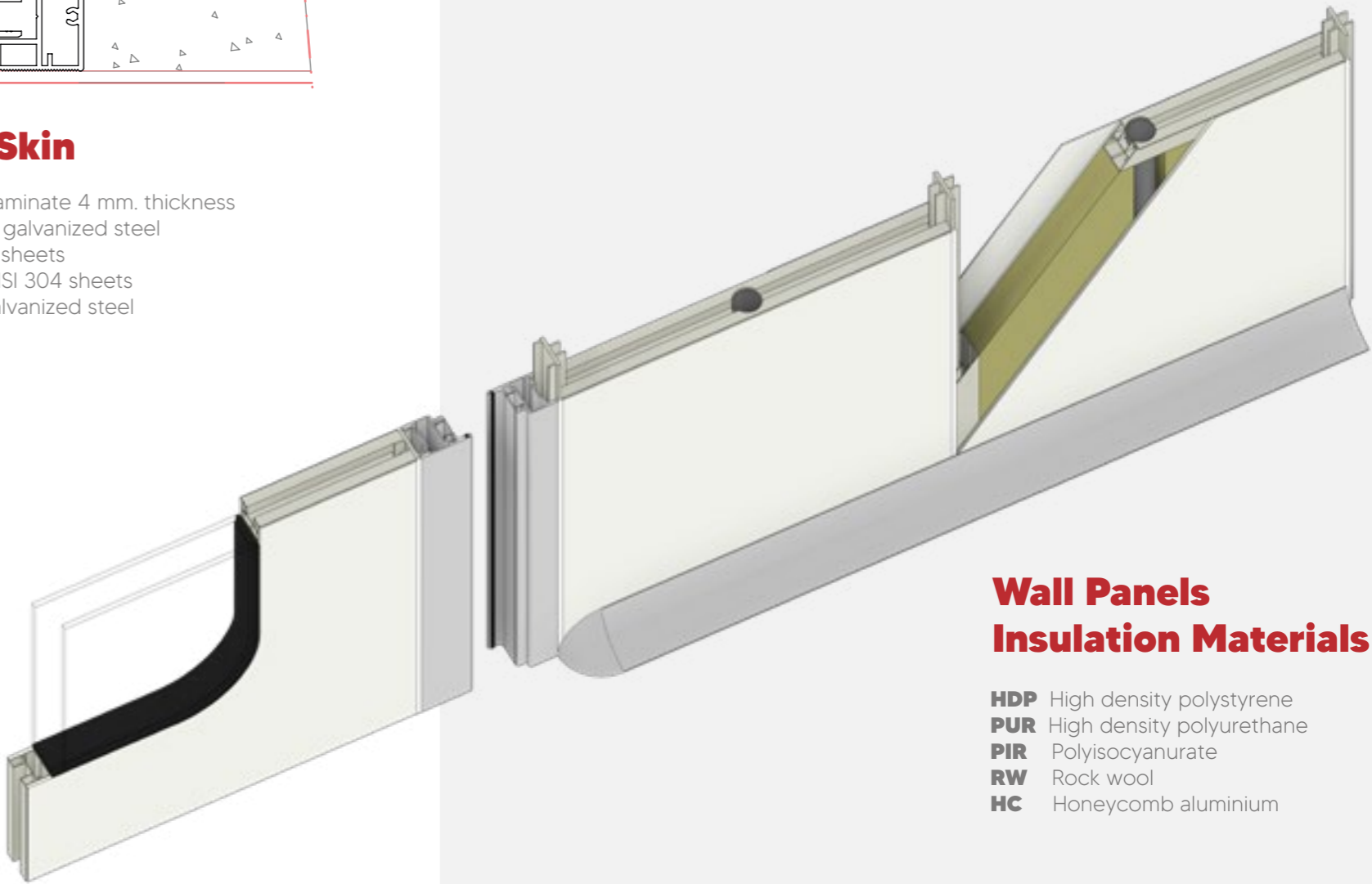

Wall Panels Insulation Materials

- HDP** High density polystyrene
- PUR** High density polyurethane
- PIR** Polyisocyanurate
- RW** Rock wool
- HC** Honeycomb aluminium

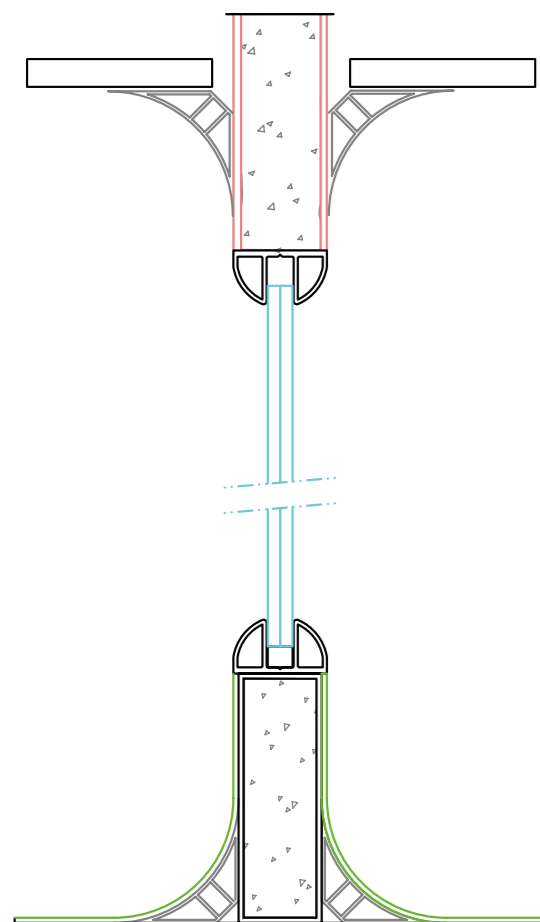

12 mm thick glass wall



Glass Walls

Can be supplied in any size

Glass walls are adopted in the pharmaceutical industry where it is necessary to inspect the rooms without having to enter with the risk of bringing contamination.



They assure great illumination to the premises allowing operators to work in a comfortable environment, who will be much more careful towards wall where glass is used.

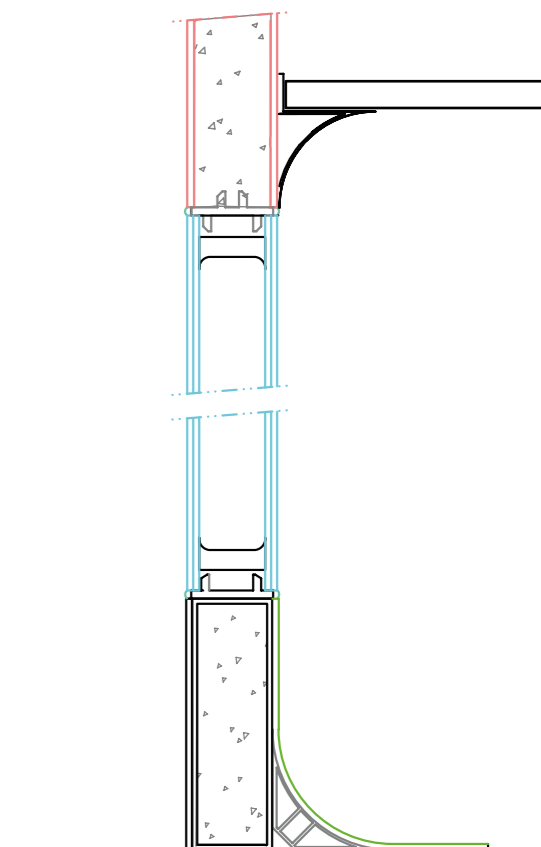

45 mm thick glass wall

Window units with dual panel safety glass

Square corners
R 10 mm



Round corners
R 98 mm



Customized
window

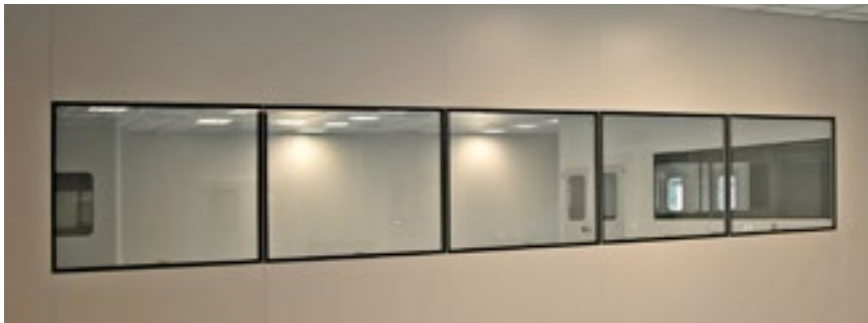
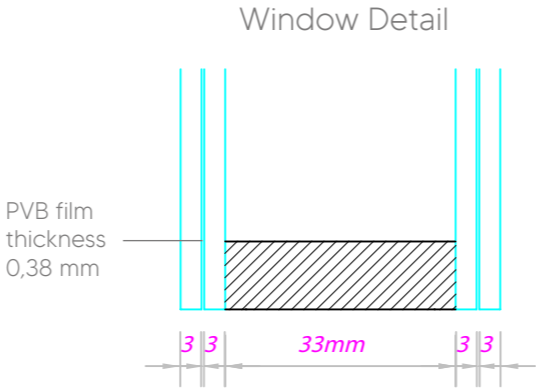

Continuous
windows



Cleanroom Doors

Our doors have rounded profiles, no visible screws, double gaskets in the frame and in the leaf with automatic drop seal at floor allowing air tight system.

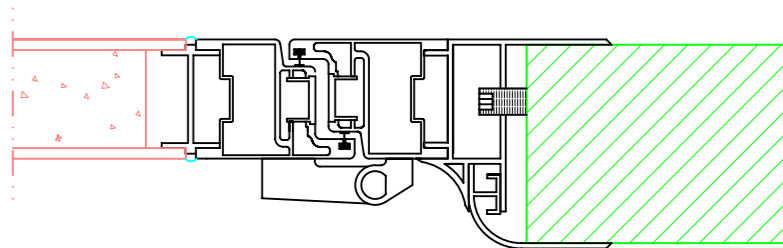

Doors air-tightness is a fundamental aspect for the calculation of the ventilation system in a clean room, where the only point of air loss is trough the doors. Nicomac designed door profiles using a CFD software to minimize losses.

Cleanroom door accessories



Open close knob



Stainless steel sanitary handle



Stainless steel fixed handle



Key-key open close knob



Anodized fixed knob



Anti-panic handle



Ergonomic handle

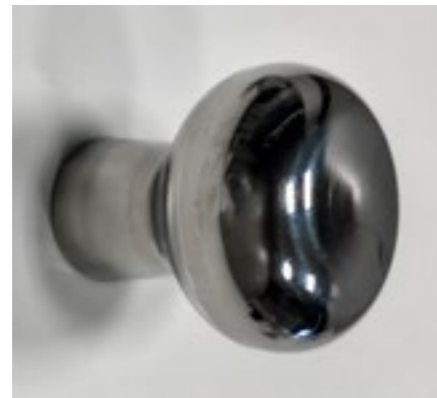

Stainless steel fixed knob



External self-closing system



Internal self-closing system

Emergency Exits



Access Controls

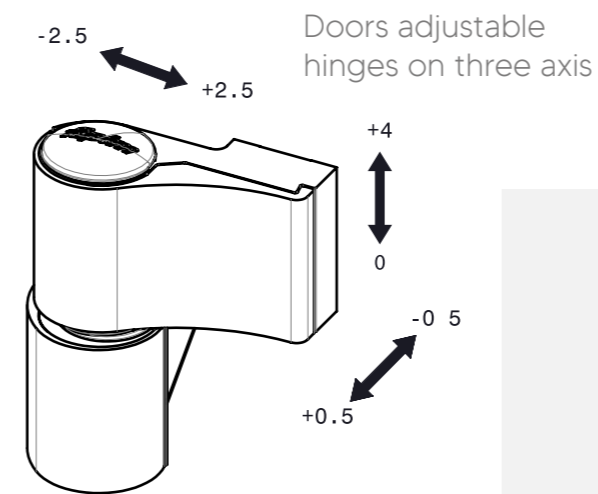

Badge reader



Numeric key pad



Light indicator with push to open and emergency button with stainless steel plate

Automatic Roll-up Doors



Air-tight roll-up door suitable for ISO 7 environments (in accordance to ISO 14644 -14)



Light indicator with open microwave, touchless system and emergency button



Roll-up door suitable for CNC or ISO 8 environments.



Open push button

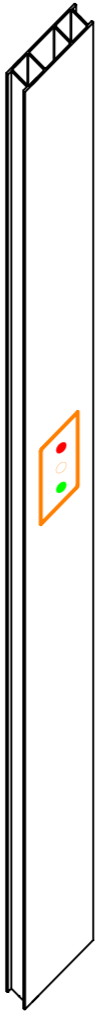

Technical panel for fixing roll-up doors and for electrical cables passages.



T-Grid Cleanroom ceiling

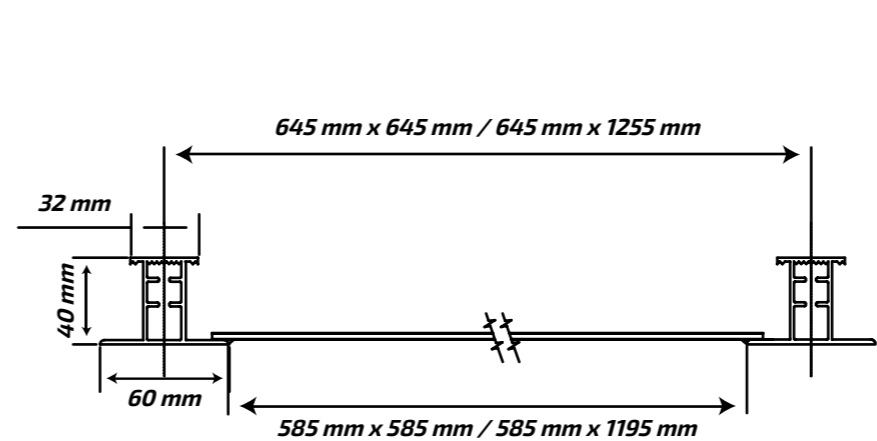

T-Grid walkable and not walkable ceiling tailored to specific needs. This modular solution offers max flexibility for HEPA filters and lights positioning. Many kind of panels are available, single sheet and sandwich type.

PPS Seamless Cleanroom walk on ceiling

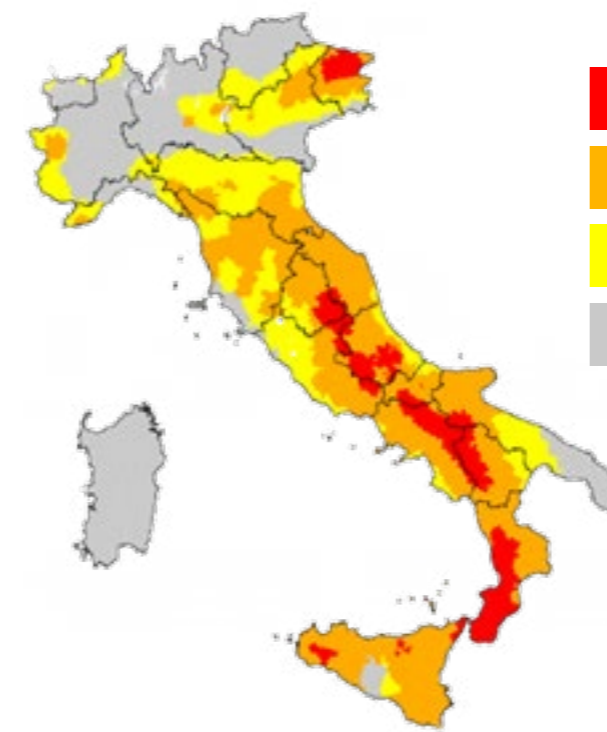

- 1 HIGH RISK
- 2 MEDIUM RISK
- 3 LOW RISK
- 4 NO RISK

Anti-Seismic false ceiling

Italy is a country at high seismic risk and, consequently, designers must take into account the anti-seismic legislation when designing “structural and not structural” building parts.

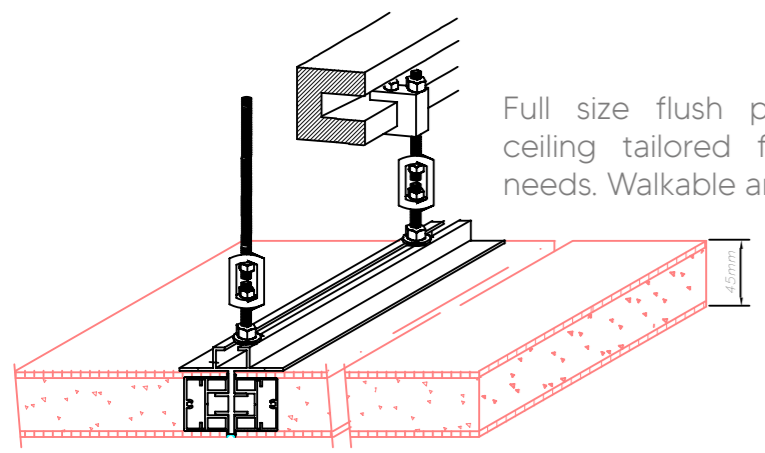
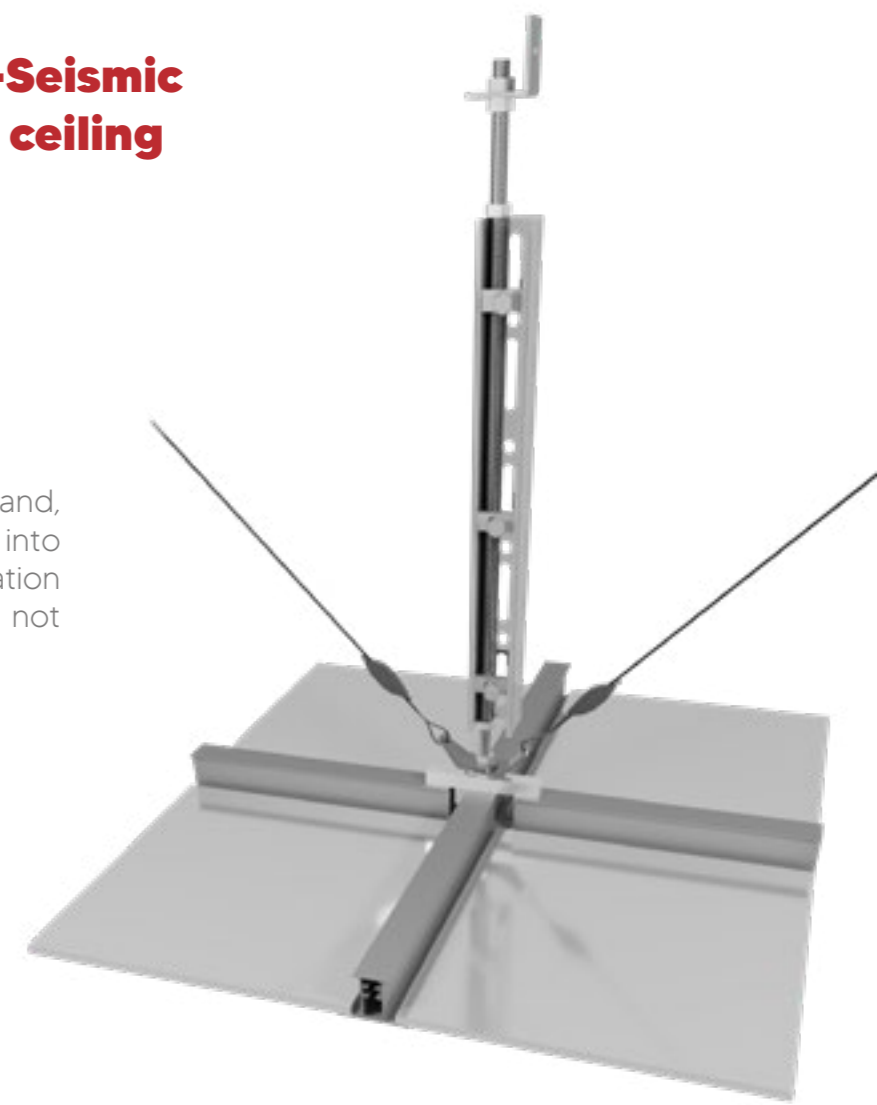

Full size flush panels false ceiling tailored for specific needs. Walkable and certified.

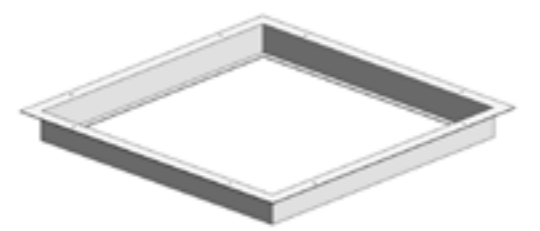

Z-Shape metal frame for HEPA filters and lights installation.

Technical area access door.



Anti-Seismic wall



Special fixing element
to compensate
bending of the beam
due to exceptional
overload (snow)

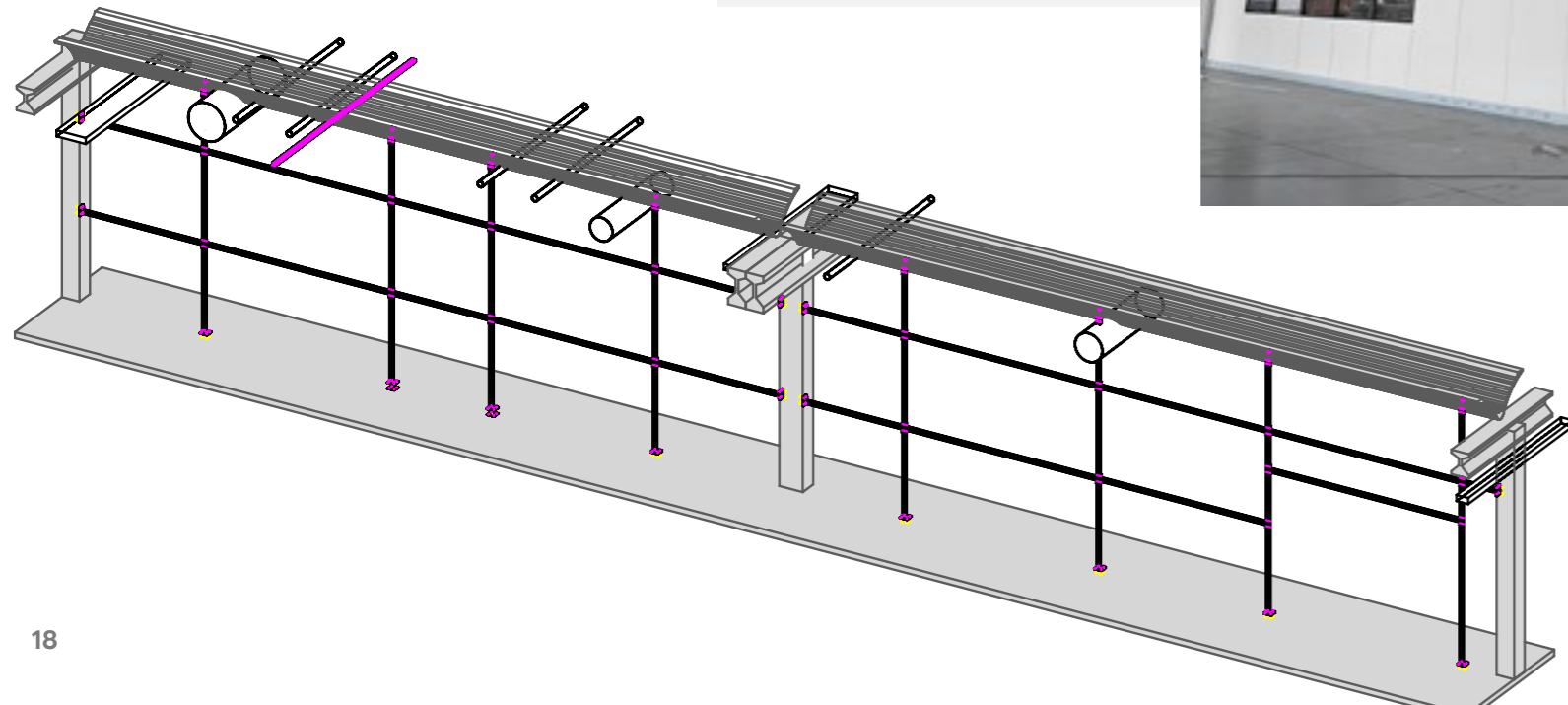

Anti-seismic metal
structure for single
high cleanroom wall

Stainless steel lockers



PAL (Personal Air Lock) gowning room

Fully integrated dressing rooms
accessories to customize and
complete your cleanroom
environment.

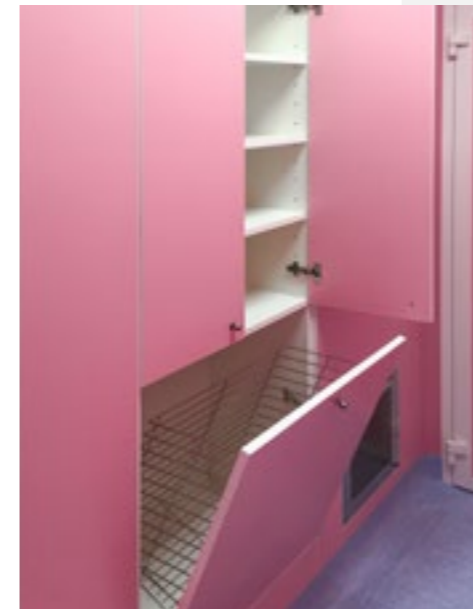

Melamine cheapboard lockers



HPL Lockers



Accessories



Stainless steel electrical sockets



Air wall system and stainless steel
flush perforated air return grilles



Stainless steel or
HPL control board
for rooms differential
pressure gauge



Fire hydrant box



LED lights embedded into false ceiling profiles

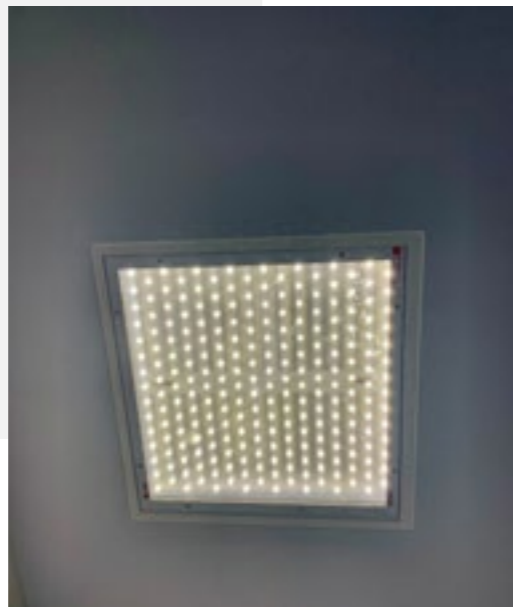

Sterile cleanrooms LED lights.
Removable screen by ST.ST screws
placed into the cleanroom side.
Available also for:
- Zone 2-22 ATEX 3 GD
- Zone 1-21 ATEX 2 GD

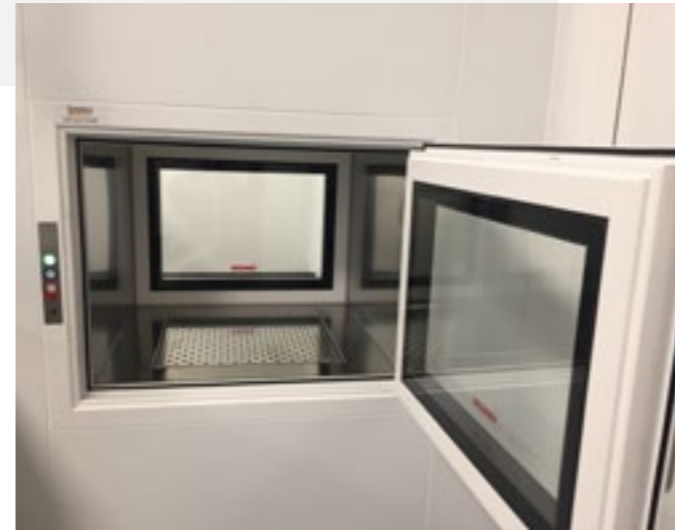

Material Pass-Through

- A** Static pass-box
- B** Passive and dynamic pass-box to be connected to HVAC system
- C** Stand-alone dynamic pass-box that includes filter and air fan

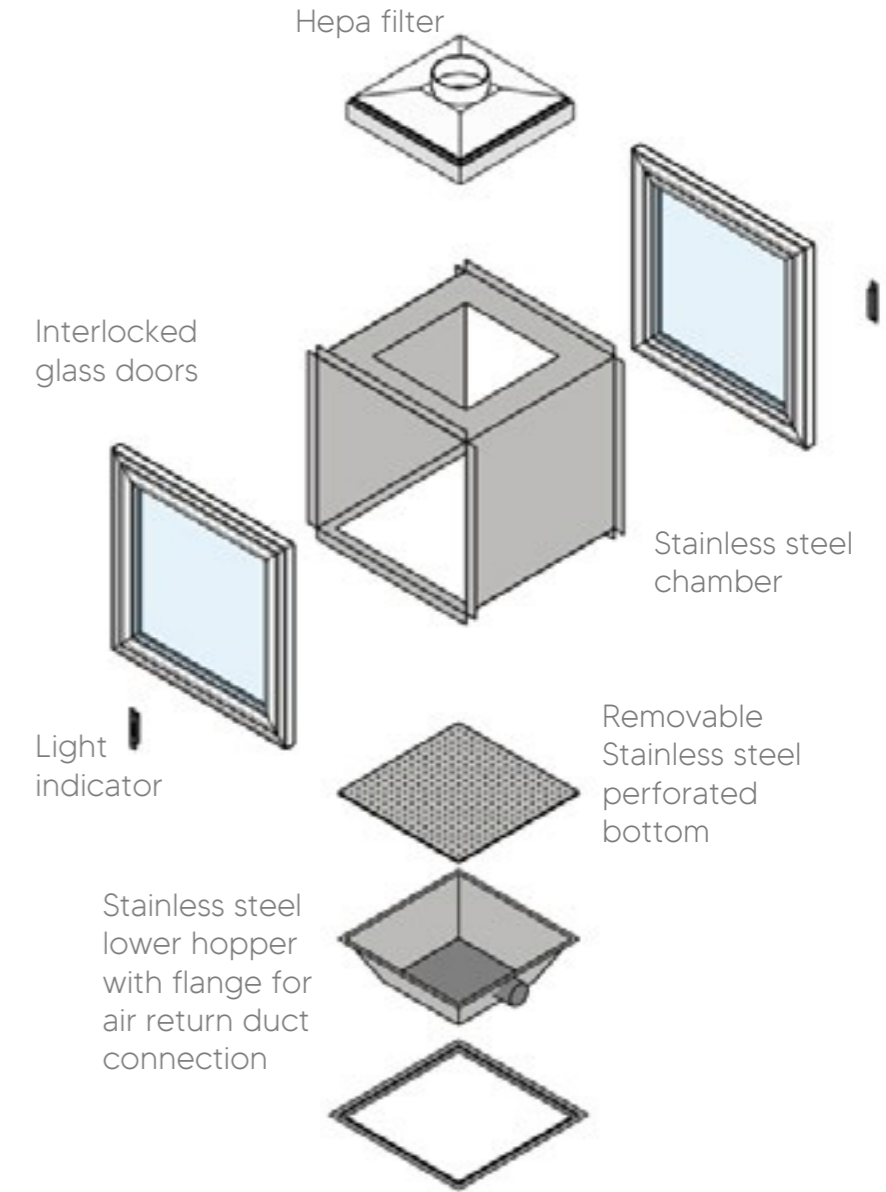

Stainless steel walls, doors
and ceiling



Digital synchronized
clock



Integrated stainless
steel sink



RABS (Restricted Access Barrier System)
with Nicomac walls and pass box



Special film for cleanroom refitting

An efficient solution for renew the surface of walls, furnitures and structures.

Very aggressive chemical environment



Before application



After application

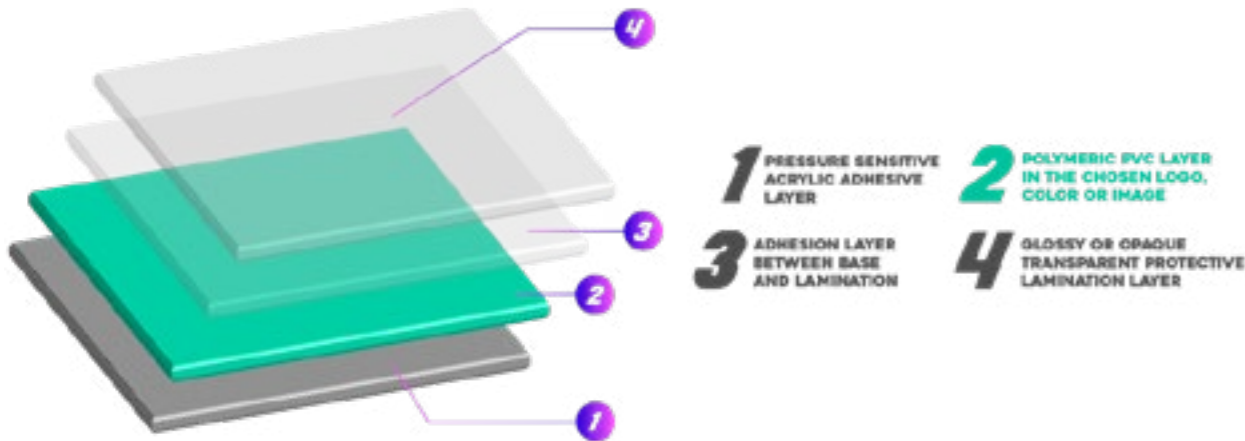

Before application



After application

Easy Panel

A convenient solution for every need



Panel to panel connection

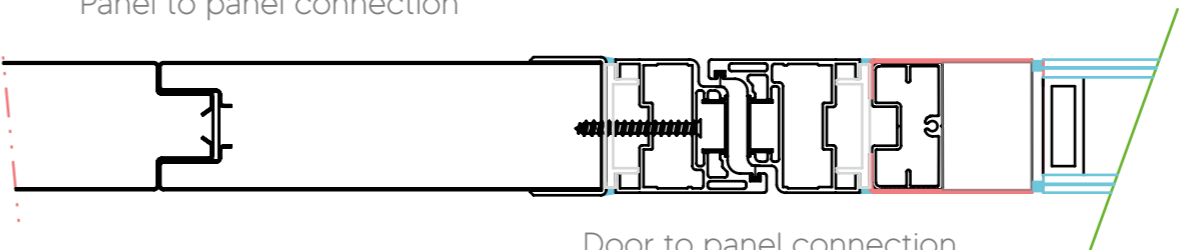

Door to panel connection

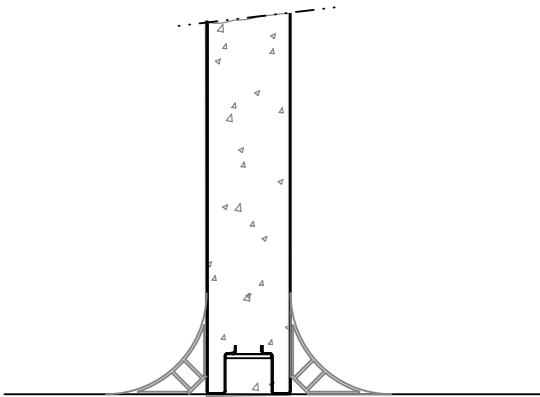

Floor to wall connection

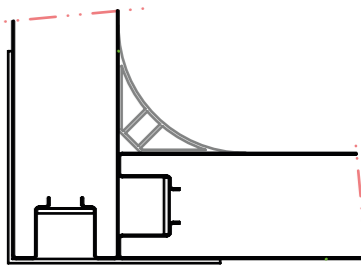

Wall to wall connection



Light metal structure to support
air ducts and false ceilings only
(100/150 kg/sqm)

Metal support structure to complete your cleanroom system

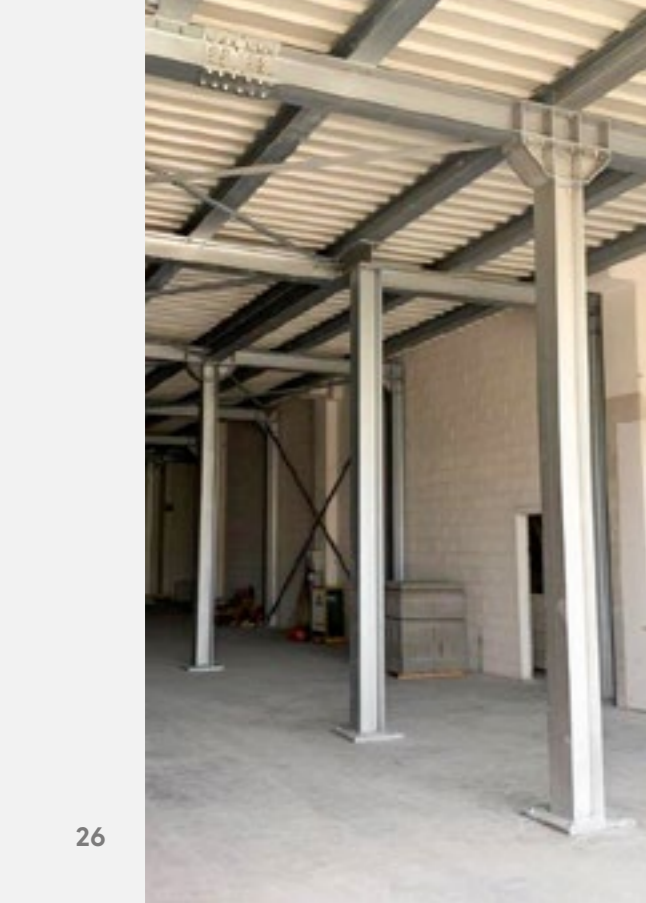

Heavy metal structure for
the creation of a technical
compartment.

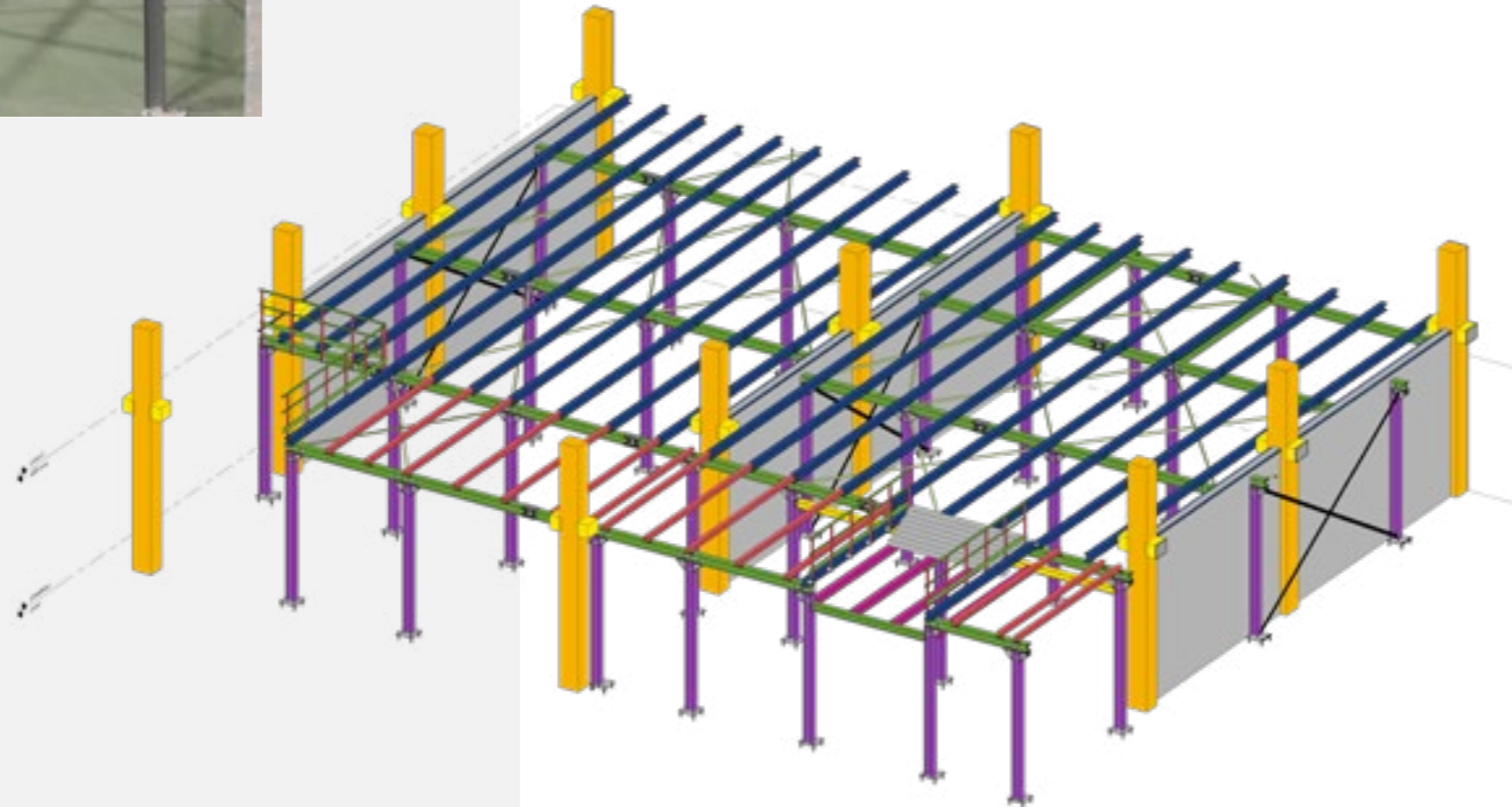

Project Design

Drawings are normally based on-site survey carried-out by Nicomac technicians.
Nicomac Europe will arrange the following drawings: rooms layout, walls front view, false ceiling layout in three different issues (for customer comments and approval, for construction and as built).



Rooms layout

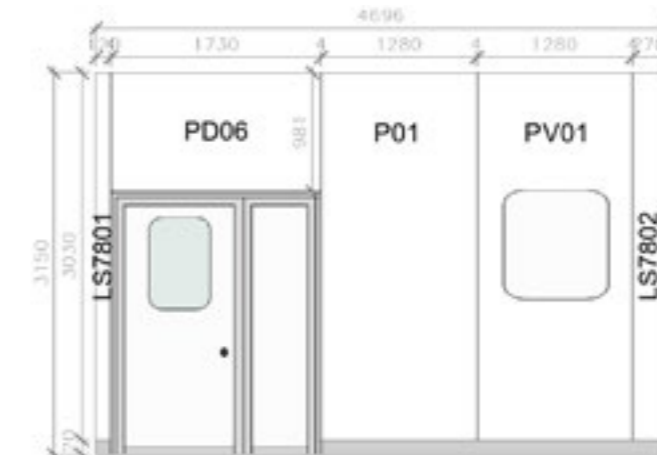

Walls front view

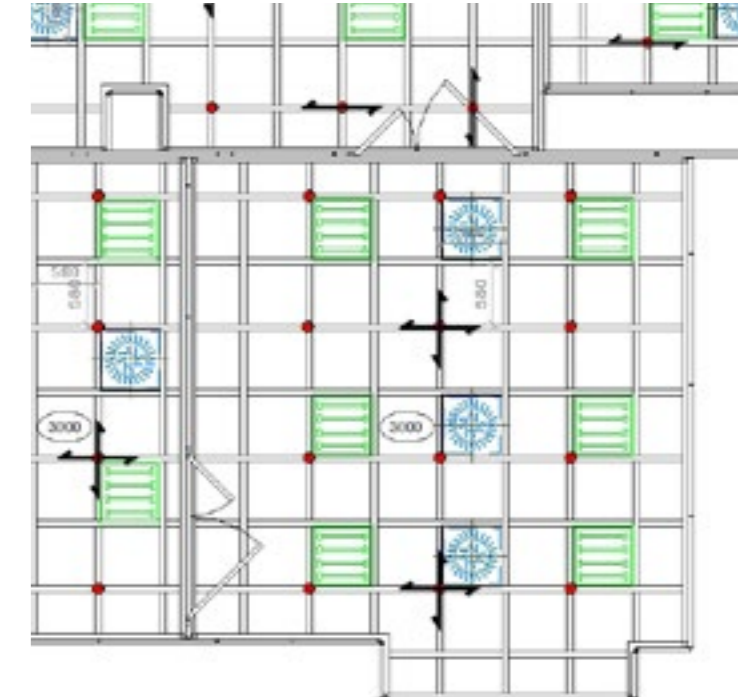

False ceiling layout

The installation teams are certified by Nicomac through continuous checks on competence, efficiency, professionalism, safety and refresher, training courses.
During the design, construction and installation, our experts and our ISO 9001 certified quality system since 1997 ensure the correct execution.



GET IN TOUCH

