

Hipharma HPL FALSE CEILING, PPS type WALK ON

WALK-ON false ceiling provided in modular units consisting of two external skins in high pressure laminate, as per enclosed HPL data sheet.

All panel sides are covered by an aluminum frame. The result is perfectly smooth, flat and very easy to clean.

Panel to panel connections are maintained with precision by aluminum profiles that create uniform seams.

Ceiling panel is fixed to the bearing structure of the customer by means of a threaded bar of complete ring.

This false ceiling is the right answer to whom need a high quality product with lighting fixture and filter maintenance access from above.

This false ceiling is designed to be walked on and tolerates a single load of 160kg. (352 Lb) of meter ceiling framework, even if located in the most unfavorable static position.

Standard panel dimension is 1280x3030mm (WxH) (approx: 4'x10')

Standard panel thickness is 45mm (≈ 1 3/4").

False ceiling panel includes:

- skin layers in high pressure laminate HPL
- insulation material
- welded rectangular aluminum framework
- H Aluminum profile between wall sections (4mm seal gap precision)
- food graded silicone sealant to caulk panel seams

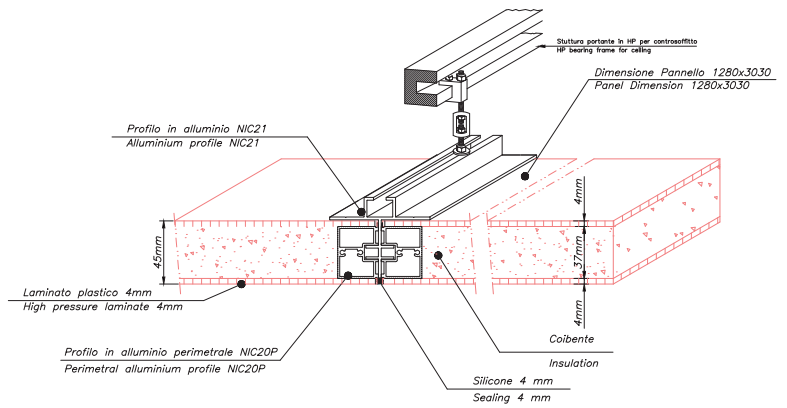

FALSE CEILING CODES	FALSE CEILING THICKNESS	INSULATION MATERIALS AND THEIR TECHNICAL FEATURES			
		POLYSTYRENE (HDP)	POLYURETHANE (PUR OR PIR)	HONEYCOMB (HC)	ROCKWOOL (RW) Vertical oriented fibers
		Density: 35kg/m ³ 2.1lb./ft ³	Density: 35kg/m ³ 2.1lb./ft ³	Density: 40kg/m ³ 2.4lb./ft ³	Density: 130kg/m ³ 8.1lb./ft ³
CTS45-PPS-PL/HDP/PL-WK	45mm/1 3/4"	●			
CTS45-PPS-PL/PUR-PIR/PL-WK	45mm/1 3/4"		●		
CTS45-PPS-PL/HC/PL-WK	45mm/1 3/4"			●	
CTS45-PPS-PL/RW/PL-WK	45mm/1 3/4"				●

FALSE CEILING CODE	STANDARDS	CLASS
CTS45-PPS-PL/RW/PL-WK	ASTM E84-12a	A
	UNI EN ISO 11925-2:2005	B-s2, d0
	UNI EN ISO 13501-1:2009	
	UNI EN ISO 13823:2010	
CTS45-PPS-PL/PUR-PIR/PL-WK	ASTM E84-12a	B
CTS45-PPS-PL/HDP/PL-WK		

THERMAL CONDUCTIVITY	STANDARDS	UNIT	VALUE
HPL plastic laminate	DIN 52612	W/m.°K	0,25
Polystyrene (HDP)	EN 12667	W/mK	0,033
Polyurethane (PUR or PIR)	ASTM C 518	Mw/m°K	22,8
Honeycomb (HC)	N.A.		
Rockwool (RW)	EN 12667	W/mK	0,040

Hipharma HPL FALSE CEILING, PPS type WALK ON

HPL INFORMATIVE TECHNICAL SHEET				
PROPERTY	TEST METHOD (EN 438:2005)	PROPERTY or ATTRIBUTE	UNIT	VALUES
Resistance to surface wear	EN 438-2.10	Wear resistance	revs	IP \geq 150
				A \geq 350
Resistance to immersion in boiling water	EN 438-2.12	Mass increase	%	CGS
				CGF
				2 \leq t < 5 \leq 5 \leq 7
		Thickness increase	%	5 \leq t \leq 2 \leq 3
				2 \leq t < 5 \leq 6 \leq 9
				5 \leq t \leq 2 \leq 6
Gloss finish	rating	\geq 3		
		Other finishes		
Resistance to dry heat (180°C)	EN 438-2.16	Gloss finish	rating	\geq 3
		Other finishes		\geq 4
Resistance to wet heat (100°C)	EN 12721	Gloss finish	rating	\geq 3
		Other finishes		\geq 4
Stability at elevated temperature	EN 438-2.17	Cumulative dimensional change	% long.	2 \leq t < 5 \leq 0,40
			% transv.	\leq 0,80
			% long.	5 \leq t \leq 0,30
			% transv.	\leq 0,60
Resistance to impact by large diameter ball	EN 438-2.21	Drop height	mm	2 \leq t < 6 \geq 1.400
				6 \leq t \geq 1.800
		Indentation diameter	mm	\leq 10 mm
Resistance to crazing (thick laminates)	EN 438-2.24	Appearance	rating	\geq 4
Resistance to scratching	EN 438-2.25	Force smooth finish	rating	\geq 2
		Force textured finish		\geq 3
Resistance to staining	EN 438-2.26	Appearance groups 1-2	rating	5
		Appearance group 3		\geq 4
Lightfastness	EN 438-2.27	Contrast	grey scale rating	\geq 4
Resistance to cigarette burns	EN 438-2.30	Appearance	rating	\geq 3
Resistance to water vapour	EN 438-2.14	Gloss finish	rating	\geq 3
		Other finishes		\geq 4
Electrical resistance	EN 61340-4-1	Rv (23°C / 50% RH)	Ohm	1x109 - 1x1011
Coefficient of linear thermal expansion	ASTM D 696	-	° C -1	L= 1,6 x 10-5 ca.
				T= 3,5 x 10-5 ca.
FIRE PERFORMANCE				
TEST METHOD	STANDARD	CLASSIFICATION		
Reaction to fire	EN 13501-1	B-s2, d0		

